



BLUE LOGIC

001 VERSATILE AND LOW WEIGHT

Submerged weight only 11 kg.

Available in 500m and 3000m depth rating versions.
Plug and Play, add PC and electrical power.

002 FLEXIBLE POWER INPUT

AC or DC input, 48 – 400VDC or 100 – 250VAC. External Power Supply available to adapt to any power supply available from the host.

003 ADAPTIVE CONTROL SYSTEM

GUI for operation via laptop/PC. Large range of settings and auto-functions. Logging of all parameters for full operational documentation. Integration with 3rd part control systems feasible.

API17H CL1-4 LIGHT WEIGHT ELECTRICAL TORQUE TOOLS

All-electric, ultra light multipurpose torque tools. Ideal for UID/AUV's, ROV's and divers.

004 POSITION ACCURACY

Output key position accuracy better than 1° with GoTo position functionality. Topside and subsea torque verification jigs available.

005 SMOOTH OPERATION

Precise motor controller enables gentle operation. Ramp-up and ramp-down feature ensures careful operation of critical applications.

006 CLASS 1-4

Easy changeout of output socket from Class 1 thru Class 4. Autodetect of socket with auto-selection of torque output in software. Gear ratio automatically changed for optimal performance and accuracy thru all torque classes.





BLUE LOGIC CL1-4 LIGHT WEIGHT ELECTRICAL TORQUE TOOLS

The Blue Logic LWETT system is based on modern servo-based electrical controlled drive system in combination with a custom-built titanium gearbox in polymeric housing resulting in the worlds lightest and most compact subsea torque tool. Torque and position control is sufficient to perform condition monitoring on valves and precise tightening of bolted connections. Rotation speed, angular position and torque output is precisely controlled, monitored and logged. Performance and accuracy is not influenced by ambient temperature in either static or dynamic operations. If DC power is not available, the compact and efficient power supply with power factor controller is a perfect option.

Dedicated Graphical User Interface included. Integration into existing control systems easily performed using the standard Modbus communication interface.

A variety of additional components and features are available:

- Torque verification jigs, both topside and subsea versions
- Inductive connector for subsea connect/disconnect
- AC-DC Power Supply (Power Factor Controller)
- Class 4-7 gearbox (torque multiplier)
- Tool for subsea replacement of output socket, class1-4

Technical Data for Torque Tool Kits

Article No.	BB6795	BB3551	BB6797	BB6796
Depth rating	500 m		3000m	
Supply Voltage	48VDC	400VDC	48VDC	400VDC
Standards	API17H/ISO 13628-8, API 17D			
Output sockets	API17H/ISO 13628-8 Class 1 - 4			
Weight in air	22,5kg	22,5kg	32,4	32,4
Weight in seawater	11,1kg	11,1kg	18,8kg	18,8kg
Max speed, low torque	2 RPM	6,0 RPM	2 RPM	6,0 RPM
Max speed, 2700Nm	1,0 RPM	6,0 RPM	1,0 RPM	6,0 RPM
High torque accuracy	+/-10% @torque above 250Nm			
Low torque accuracy	+/-10% @torque below 250Nm			
Positioning precision	+/- 1 °			
Max. power consumption	650W	2000W	650W	2000W
Max current draw	13,5A	10A	13,5A	10A
Communication	RS232 or RS485, Modbus RTU Protocol			
Electrical Interface	48V: Subconn BCR2010M 400V: Burton BCR 5507-2008			

Technical data subject to change as continuous development/improvement is ongoing.



BA7719 AC-DC Power Supply



BB2985 Torque Tool Control PC



BB2408 Class 6 - 7 Gearbox



BB3557 ROV Handle w/Latch Mec.



104212 Cl.4 Calibration Jig



BB7008 Output Socket Kit

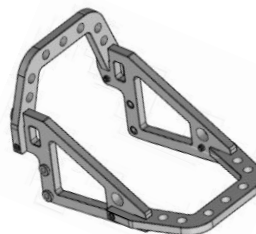

BB3676 Diver Handle



BB0167 Cl.2 Calibration Jig



BB7009 Cable Kit